

# Roller Parts

Customize your HS-rollers



## OPEN BORES

M16  
M20

UNUSUAL SIZES  
ON REQUEST



## THREADED AXLES

STOCK ITEMS: >

### OPTIONS:

- Flat Sides
- Grease Nipple
- Other sizes on request

M16 X 30  
M16 X 40  
M16 X 50  
M16 X 60  
M16 X 80  
M20 X 30  
M20 X 40  
M20 X 50  
M20 X 60  
M20 X 80

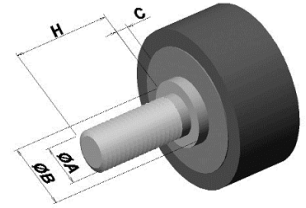

## AXLE MEASUREMENTS

A = Thread ( M10/M12 etc.)  
B = Shoulder Diameter  
C = Shoulder Length  
H = Axle Length



## BEARINGS

6005-Z  
6005-2RST ECODRIVE  
6205-2RST ECODRIVE  
6206-2RST ECODRIVE  
S6005-2RST HYBRID ECODR.  
INOX / CERAMIC Waterproof

6206-2RS COM  
6005-2RS COM S/S  
6005-2RS COM SKF  
6206-2RS COM SKF  
6308-2RS1 COM SKF

O.D. I.D.

## REMARKS

|    |    |                 |
|----|----|-----------------|
| 47 | 25 | 1 Seal          |
| 47 | 25 | 2 x Triple Seal |
| 52 | 25 | 2 x Triple Seal |
| 62 | 30 | 2 x Triple Seal |
| 47 | 25 | 2 x Triple Seal |
| 62 | 30 | 2 Seals         |
| 47 | 25 | 2 Seals         |
| 47 | 25 | 1 Seal          |
| 62 | 30 | 2 Seals         |
| 90 | 40 | 2 Seals         |



## FELT RINGS

O.D.: 44 / I.D.: 24 / W.: 7,5  
O.D.: 44 / I.D.: 24 / W.: 4,5  
O.D.: 44 / I.D.: 30 / W.: 7,5  
O.D.: 58 / I.D.: 30 / W.: 6,0

O.D. = Outside Diameter  
I.D. = Inside Diameter  
W. = Width



## DUST CAPS

Metal Dust cap: O.D. = 47  
Metal Dust cap: O.D. = 62  
Rubber Dust cap: O.D. = 47  
Plastic Dust Cap for NP-Rollers

Metal Dust ring: O.D. = 47 / I.D. = 25  
Metal Dust ring: O.D. = 62 / I.D. = 30  
Rubber Dust ring: O.D. = 47 / I.D. = 25



## METAL CONVEX RING METAL CONVEX CAP

Outside Diameter 47  
Inside Diameter 25 (ring)