

Roller Parts

Customize your HS-rollers



OPEN BORES

M16
M20

UNUSUAL SIZES
ON REQUEST



THREADED AXLES

STOCK ITEMS: >

OPTIONS:

- Flat Sides
- Grease Nipple
- Other sizes on request

M16 X 30
M16 X 40
M16 X 50
M16 X 60
M16 X 80
M20 X 30
M20 X 40
M20 X 50
M20 X 60
M20 X 80

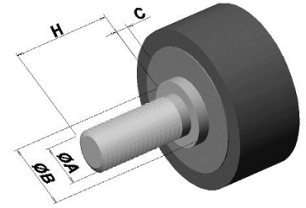

AXLE MEASUREMENTS

A = Thread (M10/M12 etc.)
B = Shoulder Diameter
C = Shoulder Length
H = Axle Length



BEARINGS

6005-Z
6005-2RST ECODRIVE
6205-2RST ECODRIVE
6206-2RST ECODRIVE
S6005-2RST HYBRID ECODR.
INOX / CERAMIC Waterproof

6206-2RS COM
6005-2RS COM S/S
6005-2RS COM SKF
6206-2RS COM SKF
6308-2RS1 COM SKF

O.D.

I.D.

REMARKS

47	25	1 Seal
47	25	2 x Triple Seal
52	25	2 x Triple Seal
62	30	2 x Triple Seal
47	25	2 x Triple Seal
62	30	2 Seals
47	25	2 Seals
47	25	1 Seal
62	30	2 Seals
90	40	2 Seals



FELT RINGS

O.D.: 44 / I.D.: 24 / W.: 7,5
O.D.: 44 / I.D.: 24 / W.: 4,5
O.D.: 44 / I.D.: 30 / W.: 7,5
O.D.: 58 / I.D.: 30 / W.: 6,0

O.D. = Outside Diameter
I.D. = Inside Diameter
W. = Width



DUST CAPS

Metal Dust cap: O.D. = 47
Metal Dust cap: O.D. = 62
Rubber Dust cap: O.D. = 47
Plastic Dust Cap for NP-Rollers

Metal Dust ring: O.D. = 47 / I.D. = 25
Metal Dust ring: O.D. = 62 / I.D. = 30
Rubber Dust ring: O.D. = 47 / I.D. = 25



METAL CONVEX RING METAL CONVEX CAP

Outside Diameter 47
Inside Diameter 25 (ring)